

● **Deckenwinkel 90° mit IG**

DIN EN 10226-1 : 2004

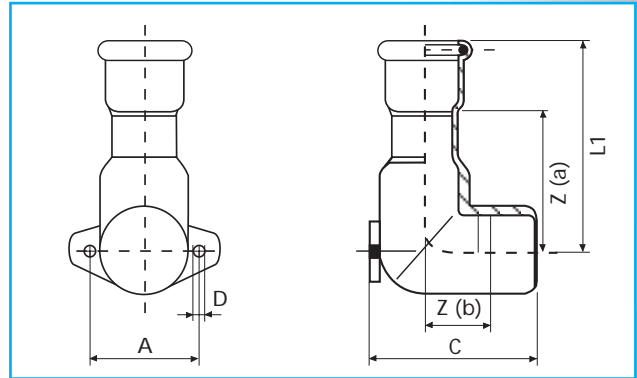

VPE	D X Rp	Artikel-Nr.	A	Z (a)	L1	C	D	Z (b)
10	15,0 x 1/2	4670020	34,0	25,0	46,0	43,0	5,0	20,0
10	18,0 x 1/2	4670021	34,0	26,0	47,0	44,0	6,0	20,0
10	22,0 x 3/4	4670022	40,0	29,0	52,0	51,0	6,0	24,0